

SPRING-LOADED PINS

DISCRETE SPRING-LOADED CONTACTS

0981

0981-0-15-20-75-14-11-0
Standard stroke, Surface mount

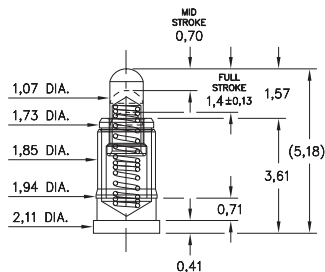

7982

7982-1-15-20-75-14-11-0
Standard stroke
Solder mount in 0,74 min. mounting hole

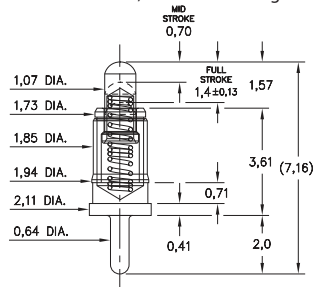

7983

7983-1-15-20-75-14-11-0
Standard stroke, Knurl Press-fit in 1,57 mounting hole. Accepts wire sizes up to 22 AWG

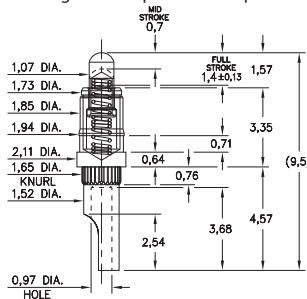

Material Specifications:

Sleeve & Plunger Material: Copper Alloy
Spring Material: Beryllium Copper
Sleeve & Plunger Finish: 0,5µm Gold over Nickel
Spring Finish: 0,25µm Gold over Nickel
Dimensions: Millimeters
Tolerances On: Lengths: ± 0,15
 Diameters: ± 0,051
 Angles: ± 2°



Mechanical & Electrical Specifications:

Durability: Up to 1,000,000 cycles
Rated Current per IEC 60512-5:
 Continuous 6 amps @ 30° C temperature rise
Contact Resistance: 20 mΩ max.
Environmental Specifications:
Operating temperature range:
 -55/+125° C (discontinuous)

Order Code: XXXX - 0 - 15 - 20 - 75 - 14 - 11 - 0

Spring Number 75

Spring Number	Mid. Stroke	Max. Stroke	Force @ Mid. Stroke	Initial Force (Pre-Load)
75	0,7	1,4	60 g	25 g

