

REVISIONS						
REV	ECO NO.	DESCRIPTION	BY	DATE	APP'D BY	DATE
1	29368	INITIAL RELEASE	H. KOUATLI	6/24/2025	K. KOONS	6/24/2025

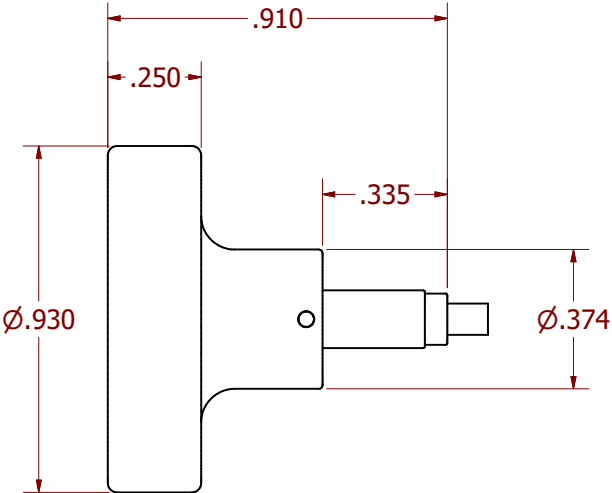

ISOMETRIC VIEW  
FOR REF ONLY

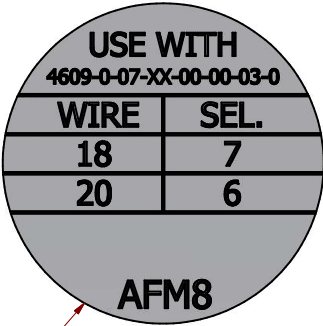
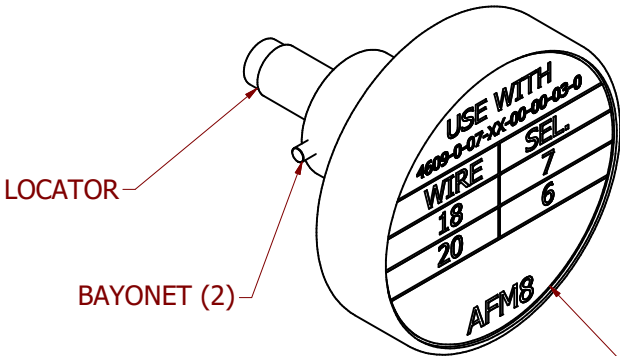

LOCATOR	
HOLE DIMENSIONS	ADDITIONAL FEATURES
Ø.090 ▽.370	

UNCONTROLLED DOCUMENT  
WILL NOT BE UPDATED

DIMENSIONS IN INCHES - UNLESS OTHERWISE SPECIFIED  
RESTRICTED & CONFIDENTIAL

CONFIDENTIAL PROPERTY OF DANIELS MANUFACTURING CORP. NOT TO BE DISCLOSED TO OTHERS. REPRODUCTION OR USED FOR ANY OTHER PURPOSE EXCEPT AS AUTHORIZED IN WRITING BY DANIELS MANUFACTURING. MUST BE RETURNED TO DANIELS MANUFACTURING CORP. ON COMPLETION OF ORDER OR PURPOSES FOR WHICH LENT.

DRN. H.KOUATLI	DATE 6/24/2025	INTERPRET PER ASME Y14.5M-2018	
CHK'D K. KOONS	DATE 6/24/2025	DANIELS MANUFACTURING CORP. ORLANDO, FLORIDA CAGE 11851	
APP'D T.KUHL	DATE 6/24/2025		
NOTE: THIS DRAWING IS AN OUTLINE DRAWING OF THE RESPECTIVE DMC PART NUMBER INDICATED.		TITLE POSITIONER ENVELOPE DRAWING	
WHERE USED: AFM8		SIZE B	SCALE N.T.S.
		CAD NO. K2204_ENV	SHEET 1 OF 1
		PART NO. K2204	REV. 1