

MAXIMUM SOLUTIONS

Rugged, High Current Spring Pins



Mill-Max now offers a series of rugged spring pins capable of carrying 9 amps continuous current at a low 10° C temperature rise. The Mill-Max 0850, 0851, 0852 and 0853 spring pins are the perfect solution for rugged applications and for use in circuits operating at currents above signal level.

The 085X series is characterized by a greater mass and surface area which provides a lower resistance electrical path than miniature spring pins. Because they are designed and built with the same precision of our miniature spring pins they exhibit excellent signal integrity in shock and vibration environments.

These large scale spring pins feature a gold plated stainless steel spring, .050" (1.27 mm) diameter solid plunger and thick wall construction to withstand the rigors of demanding applications. Designed for through hole mounting, each pin has a large diameter post and flange providing for a perpendicular and secure PCB attachment.

The 085X series provides a generous .045" (1.14 mm) mid-stroke and .090" (2.29 mm) maximum stroke allowing for use in applications where stack up tolerances are great. Applications include board stacking, docking stations, cable assemblies, quick connects and anywhere there is a blind mate situation.

Rated at 1,000,000 cycles minimum, the Mill-Max 085X series spring pins are the best choice for higher-current, high reliability spring pin requirements.

For more information, visit: www.mill-max.com/PR617.

SPRING-LOADED PINS

DISCRETE SPRING-LOADED CONTACTS • POWER SPRING PINS

0850

0850-0-15-20-83-14-11-0
Power spring pin
Solder Mount in .090 min. mounting hole

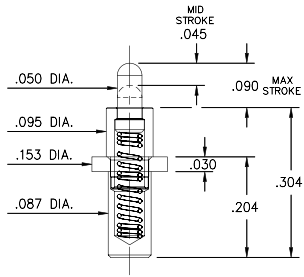

0851

0851-0-15-20-82-14-11-0
Power spring pin
Solder Mount in .090 min. mounting hole

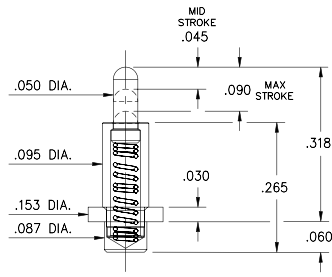

0853

0853-0-15-20-82-14-11-0
Power spring pin
Solder Mount in .090 min. mounting hole

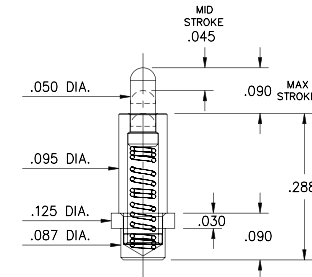

0852

0852-0-15-20-83-14-11-0
Power spring pin
Solder Mount in .043 min. mounting hole

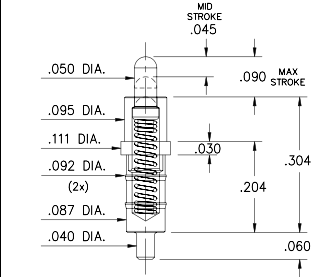

0854

0854-0-15-20-82-14-11-0
Power spring pin, Soldercup
Accepts wire sizes up to .057" Dia.

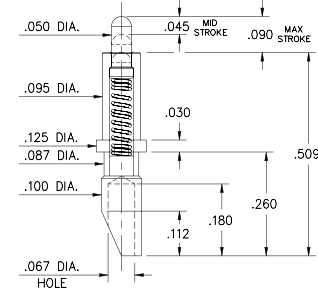

0855

0855-0-15-20-82-14-11-0
Power spring pin, Wire termination for wire sizes 16 AWG Max. / 20 AWG Min.

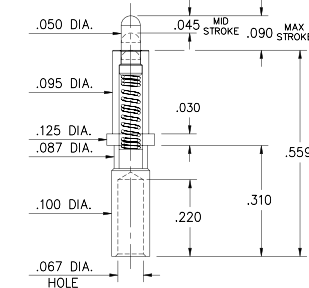

0856

0856-0-15-20-82-14-11-0
Power spring pin
Solder Mount in .043 min. mounting hole

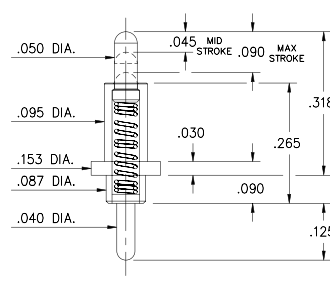

0861

0861-0-15-20-82-14-11-0
Solder Mount in .043 min. mounting hole
*Force @ Mid. Stroke 100g

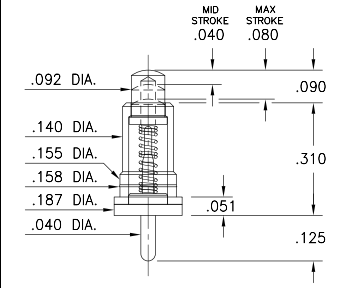

0871

0871-0-15-20-82-14-11-0
Long stroke, Surface Mount
*Force @ Mid. Stroke 100g

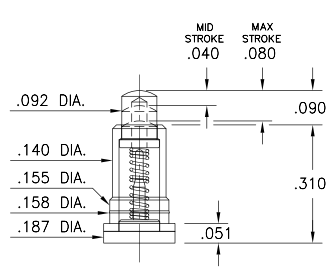

Material Specifications:

Sleeve & Plunger Material: Copper Alloy
Spring Material: Stainless Steel 302
Sleeve & Plunger Finish: 20 μ" Gold over Nickel
Spring Finish: 10 μ" Gold over Nickel
Dimensions: Inches
Tolerances On: Lengths: ±.006
Diameters: ±.002
Angles: ±2°



Mechanical & Electrical Specifications:

Durability: 1,000,000 cycles
Rated Current (Free air):
Continuous 9 amps @ 10° C temperature rise
Contact Resistance: 20 mΩ max.
Environmental Specifications:
Operating temperature range: -55/+125° C

82, 83 Springs are not interchangeable

Order Code: 08XX - X - 15 - 20 - 8X - 14 - 11 - 0

Spring Number ↑

Spring Number	Mid. Stroke	Max. Stroke	Force @ Mid. Stroke	Initial Force (Pre-Load)
* 82	.045	.090	120 g	25 g
83	.045	.090	120 g	25 g

