

MAXIMUM SOLUTIONS

Mill-Max Offers 3 Additional High Current Spring Pins



Mill-Max is pleased to announce the addition of three new large scale, high current spring pins to our expanding family of ruggedized spring-loaded products. In contrast to our miniature spring pins, which are typically used on .100" (2.54 mm) centers, these new offerings are for applications where greater spacing is required due to electrical and mechanical specifications.

All three are rugged spring pins, rated at 9 amps and designed with unique termination features. MM 0854-0-15-20-82-14-11-0 has a solder cup while MM 0855-0-15-20-82-14-11-0 is designed with a crimp barrel – both can accept wire diameters up to 16AWG. MM 0856-0-15-20-82-14-11-0 has a solder tail for PCB mount assembly.

Inside each MM 0854, 0855 and 0856 spring pin is a gold-plated, stainless steel spring rated for 1,000,000 cycles. Gold plating provides the highest interconnect reliability, corrosion protection and wear resistance. MM large scale spring pins have a .045" (1.143 mm) working travel (.090" [2.286 mm] maximum travel) and exhibit higher spring forces than smaller miniature spring pin connectors. In addition, these spring pins feature thick wall construction and solid plungers for increased durability.

As with all Mill-Max spring pins, the components are made from brass alloy, high-speed machined to precision tolerances and gold-plated for excellent mechanical, thermal and conductive properties. Mill-Max large scale spring pins are typically used in cable, front panel, board stacking and docking station applications.

For more information, please visit: www.mill-max.com/PR622.

(7/14 -- PR622)

Mill-Max Mfg. Corp. • 190 Pine Hollow Road, Oyster Bay, NY 11771
516-922-6000 • Fax: 516-922-9253 • www.mill-max.com



SPRING-LOADED PINS

DISCRETE SPRING-LOADED CONTACTS • POWER SPRING PINS

0850

0850-0-15-20-83-14-11-0

Power spring pin
Solder Mount in .090 min. mounting hole

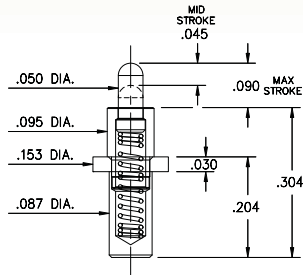

0851

0851-0-15-20-82-14-11-0

Power spring pin
Solder Mount in .090 min. mounting hole

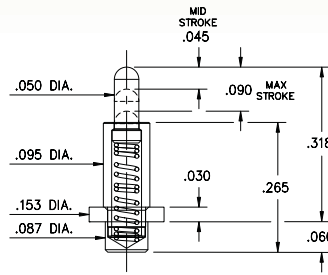

0853

0853-0-15-20-82-14-11-0

Power spring pin
Solder Mount in .090 min. mounting hole

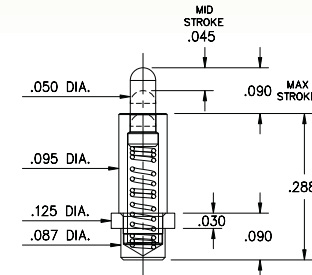

0852

0852-0-15-20-83-14-11-0

Power spring pin
Solder Mount in .043 min. mounting hole

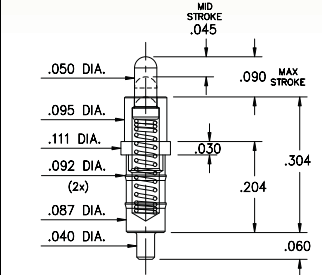

0854

0854-0-15-20-82-14-11-0

Power spring pin, Soldercup
Accepts wire sizes up to .057" Dia.

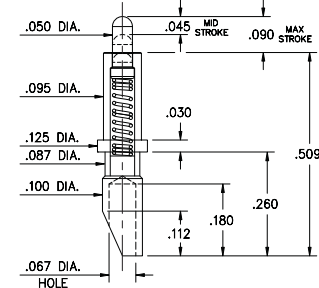

0855

0855-0-15-20-82-14-11-0

Power spring pin, Wire termination for
wire sizes 16 AWG Max. / 20 AWG Min.

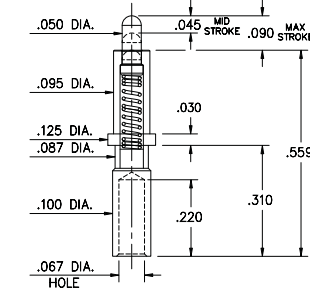

0856

0856-0-15-20-82-14-11-0

Power spring pin
Solder Mount in .043 min. mounting hole

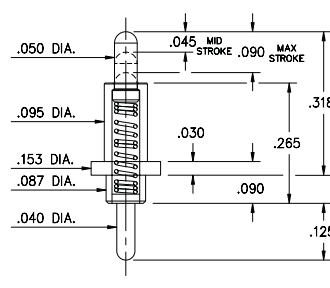

Material Specifications:

Sleeve & Plunger Material: Copper Alloy
Spring Material: Stainless Steel 302
Sleeve & Plunger Finish: 20 μ" Gold over Nickel
Spring Finish: 10 μ" Gold over Nickel
Dimensions: Inches
Tolerances On: Lengths: ±.006
Diameters: ±.002
Angles: ±2°



Mechanical & Electrical Specifications:

Durability: 1,000,000 cycles
Rated Current (Free air):
Continuous 9 amps @ 10° C temperature rise
Contact Resistance: 20 mΩ max.
Environmental Specifications:
Operating temperature range: -55/+125° C

82, 83 Springs are not interchangeable

Order Code: 08XX - X - 15 - 20 - **8X** - 14 - 11 - 0

Spring Number

Spring Number	Mid. Stroke	Max. Stroke	Force @ Mid. Stroke	Initial Force (Pre-Load)
82	.045	.090	120 g	25 g
83	.045	.090	120 g	25 g

